

Town and Country Planning Act 1990

The Borough Council of Oadby & Wigston (The Oval, Oadby)

Tree Preservation Order 2021

The Borough Council of Oadby & Wigston, in exercise of the powers conferred on them by sections 198 of the Town and Country Planning Act 1990 hereby make the following Order:-

Citation

1. This Order may be cited as The Borough Council of Oadby & Wigston (The Oval, Oadby) Tree Preservation Order 2021

Interpretation

2. (1) In this Order "the authority" means the Borough Council of Oadby and Wigston unless the context otherwise requires.
(2) In this Order any reference to a numbered section is a reference to the section so numbered in the Town and Country Planning Act 1990 and any reference to a numbered regulation is a reference to the regulation so numbered in the Town and Country Planning (Tree Preservation) (England) Regulations 2012.

Effect

3. (1) Subject to article 4, this Order takes effect provisionally on the date on which it is made.
(2) Without prejudice to subsection (7) of section 198 (power to make tree preservation orders) or subsection (1) of section 200 (tree preservation orders: Forestry Commissioners) and, subject to article 14, no person shall-
 - (a) cut down; top; lop; uproot; wilfully damage; or wilfully destroy; or
 - (b) cause or permit the cutting down, topping, lopping, wilful damage or wilful destruction of, any tree in the Schedule of this Order except with the written consent of the authority in accordance with regulations 16 and 17, or of the Secretary of State in accordance with regulation 23, and, where such consent is given subject to conditions, in accordance with those conditions.

Application to trees to be planted pursuant to a condition

4. In relation to any tree identified in the first column of the Schedule by the letter "C", being a tree to be planted pursuant to a condition imposed under paragraph (a) of section 197 (planning permission to include appropriate provision for preservation and planting of trees), this Order takes effect as from the time when the tree is planted.

Dated this **8** day of **JANUARY** 2021.

The Common Seal of the Borough Council of Oadby and Wigston
was hereunto affixed in the presence of:-

(Head of Law & Democracy)



08/20/21

CONFIRMATION OF ORDER

This Order was confirmed by the Oadby and Wigston Borough Council at its meeting of the Development Control Committee/under delegated powers* without modification on the day of 202

Minute Reference:

Officer:

CONFIRMATION OF ORDER SUBJECT TO MODIFICATION

This Order was confirmed by the Oadby and Wigston Borough Council at its meeting of the Development Control Committee/under delegated powers* on the day of 20 , subject to the following modifications:

Minute Reference:

Officer:

DECISION NOT TO CONFIRM ORDER

A decision not to confirm this Order was taken by Oadby and Wigston Borough Council at its meeting of the Development Control Committee/under delegated powers* on the day of 20 .

Minute Reference:

Officer:

DECISION TO VARY ORDER

A decision to vary this Order was taken by Oadby and Wigston Borough Council at its meeting of the Development Control Committee/under delegated powers* on the day of 20 .

Minute Reference:

Officer:

DECISION TO REVOKE ORDER

A decision to revoke this Order was taken by Oadby and Wigston Borough Council at its meeting of the Development Control Committee on the day of 201 .

Minute Reference:

* Delete as appropriate

SCHEDULE

SPECIFICATION OF TREES

Trees specified Individually

(encircled in black on the map)

Reference on map	Description	Situation
T1	<i>Fagus sylvatica</i> (Common Beach)	South eastern boundary of land at 11 The Oval, Oadby
T2	<i>Fraxinus excelsior</i> (Common Ash)	Within the curtilage of land at 11 The Oval, Oadby
T3	<i>Acer pseudoplatanus</i> (Sycamore)	Northern boundary of land at 11 The Oval, Oadby
T4	<i>Fraxinus excelsior</i> (Common Ash)	Northern boundary of land at 12 The Oval, Oadby
T5	<i>Acer pseudoplatanus</i> (Sycamore)	North western boundary of 12 The Oval, Oadby
T6	<i>Fagus sylvatica</i> (Common Beach)	Western boundary of 12 The Oval, Oadby
T7	<i>Pinus sylvestris</i> (Scots Pine)	Western boundary of 12 The Oval, Oadby
T8	<i>Pinus sylvestris</i> (Scots Pine)	Western boundary of 12 The Oval, Oadby
T9	<i>Acer pseudoplatanus</i> (Sycamore)	Western boundary of 12 The Oval, Oadby
T10	<i>Acer pseudoplatanus</i> (Sycamore)	Western boundary of 12 The Oval, Oadby
T11	<i>Acer pseudoplatanus</i> (Sycamore)	Western boundary of 12 The Oval, Oadby
T12	<i>Acer pseudoplatanus</i> (Sycamore)	Western boundary of 12 The Oval, Oadby
T13	<i>Acer pseudoplatanus</i> (Sycamore)	Western boundary of 12 The Oval, Oadby

T14	Acer pseudoplatanus (Sycamore)	Western boundary of 12 The Oval, Oadby
T15	Chamaecyparis lawsoniana (Lawson Cypress)	Within the curtilage of land at 12 The Oval, Oadby
T16	Chamaecyparis lawsoniana (Lawson Cypress)	Towards the eastern boundary of land at 12 The Oval, Oadby
T17	Chamaecyparis lawsoniana (Lawson Cypress)	Towards the western boundary of land 11 The Oval, Oadby
T18	Acer pseudoplatanus (Sycamore)	Western boundary of 15 The Oval, Oadby
T19	Acer pseudoplatanus (Sycamore)	Western boundary of 15 The Oval, Oadby
T20	Acer pseudoplatanus (Sycamore)	Western boundary of 16 The Oval, Oadby
T21	Acer pseudoplatanus (Sycamore)	Western boundary of 17 The Oval, Oadby
T22	Acer pseudoplatanus (Sycamore)	Western boundary of 20 The Oval, Oadby
T23	Acer pseudoplatanus (Sycamore)	Western boundary of 20 The Oval, Oadby
T24	Tilia sp. (Lime)	Southern boundary of 20 The Oval, Oadby
T25	Aesculus hippocastanum (Horse Chestnut)	21 The Oval, Oadby
T26	Aesculus hippocastanum (Horse Chestnut)	21 The Oval, Oadby
T27	Castanea sativa (Sweet Chestnut)	37 The Oval, Oadby
T28	Fagus sylvatica (Common Beach)	Frontage of 4 The Oval, Oadby
T29	Thuja plicata 'Zebrina' (Western red cedar Zebrina)	Frontage of 9 the Oval, Oadby
T30	Pinus sylvestris (Scots Pine)	Frontage of 9 the Oval, Oadby

T31	Fagus sp. (Beech)	Frontage of 9 the Oval, Oadby
T32	Tilia so. (Lime)	Frontage of 9 the Oval, Oadby

Trees specified by reference to an Area

(within a dotted black line on the map)

Reference on map	Description	Situation
------------------	-------------	-----------

Groups of Trees

(within a broken black line on the map)

Reference on map	Description	Situation
G1	Mixed Species (4no. Acer pseudoplatanus (Sycamore) and 1no. Fagus sylvatica (Common Beech))	Northern Boundary of land at 10 The Oval, Oadby
G2	3no. Ilex aquifolium (Common Holly)	Southern boundary of land at 12 The Oval, Oadby
G3	3no. Ilex aquifolium (Common Holly)	Eastern boundary of land at 11 The Oval, Oadby

Woodlands

(within a continuous black line on the map)

Reference on map	Description	Situation
------------------	-------------	-----------

Oadby and Wigston Borough Council (The Oval, Oadby)

Tree Preservation Order 2020

Scale 1:1000

Date 08/01/2021

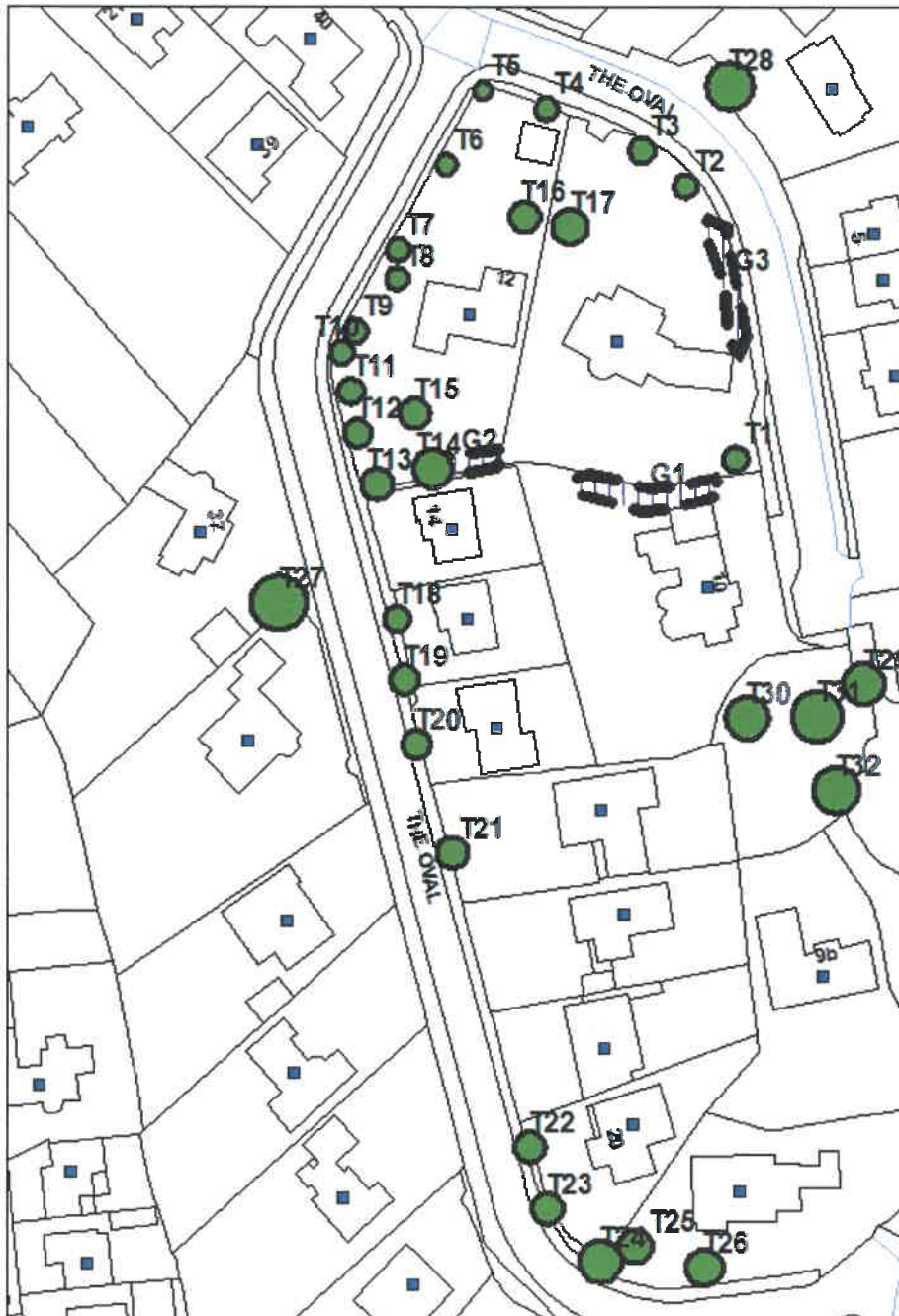

Handwritten signature



08/20/21
a

